

GENERATOR REMOVAL/INSTALLATION [ZJ, Z6]

B3E011718300W01

Warning

- When the battery cables are connected, touching the vehicle body with generator terminal B generates sparks. This can cause personal injury, fire, and damage to the electrical components. Always disconnect the negative battery cable before performing the following operation.

1. Remove the battery cover. (See [BATTERY REMOVAL/INSTALLATION \[ZJ, Z6\].](#))
2. Disconnect the negative battery cable.
3. Remove the under cover and splash shield as a single unit.
4. Remove the drive belt. (See [DRIVE BELT REPLACEMENT \[ZJ, Z6\].](#))
5. Set the coolant reserve tank out of the way.
6. Set the power steering fluid tank out of the way.
7. Remove in the order indicated in the table.
8. Install in the reverse order of removal.

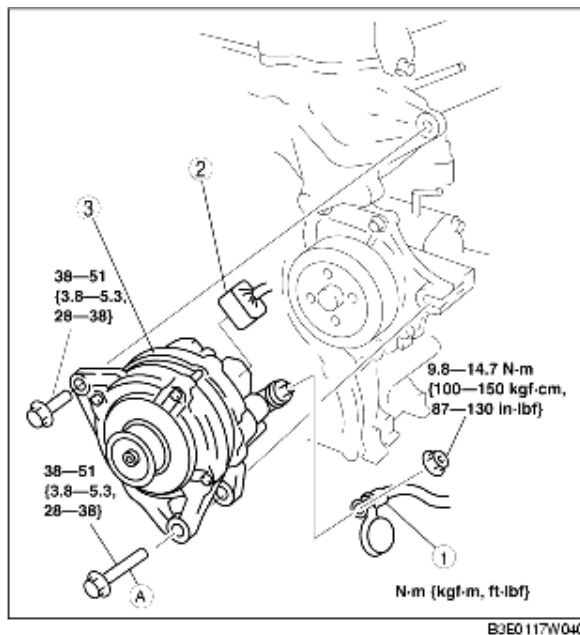

1	Terminal B cable
2	Generator connector
3	Generator (See Generator Removal Note.)

Generator Removal Note

1. Remove bolt A with the generator since there is not enough space.